

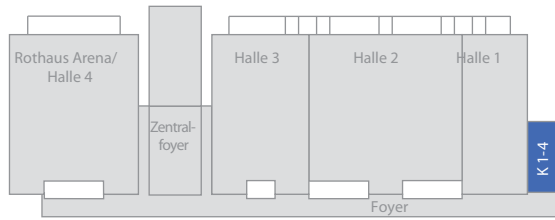





K 1 – 4



## Konferenzraum 1-4 – Konferenzbestuhlung Einzelbelegung

-  Aufzug
-  Technische Einrichtungen
-  Säulen
-  Stühle
-  Tische

Technik:  
Telefon (analog, ISDN, S0)  
W-Lan  
Klimatisierung  
Verdunkelung

K1 100 m<sup>2</sup>

44 Plätze

K2 60 m<sup>2</sup>

30 Plätze

K3 60 m<sup>2</sup>

30 Plätze

K4 80 m<sup>2</sup>

36 Plätze

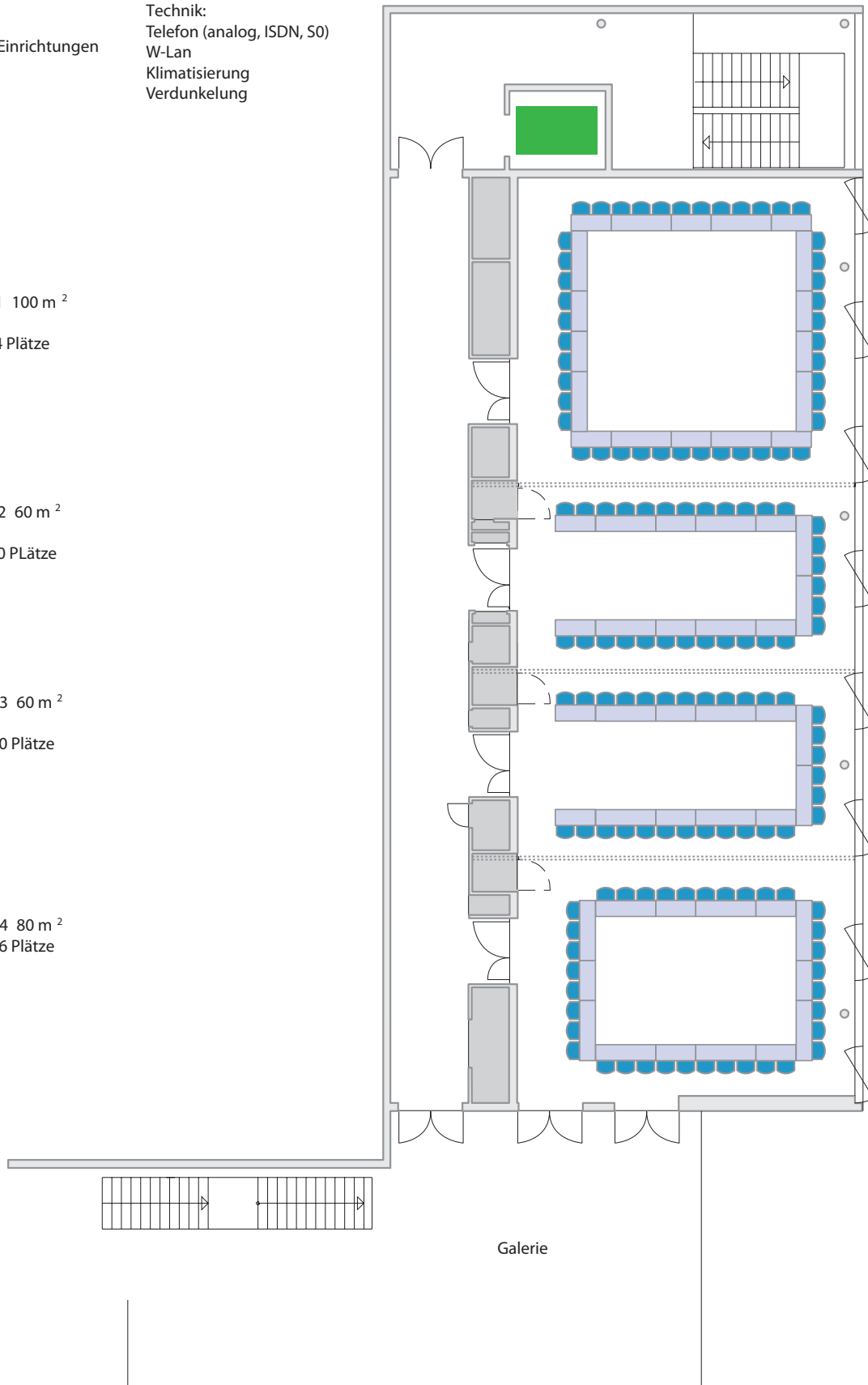

Galerie